

# Dawson's Style Guide

## *West Australian Cottage Planting Guide*

*The Cottage garden style is still the most popular garden theme in Australia. The perfect Cottage garden, is a mixture of colours, textures and fragrance, which combine to create a relaxed and informal atmosphere. The West Australian Cottage garden uses a variety of suitable plants from around the world to create a vibrant, colourful garden in our climate.*

### **Climbers:**

*Climbers are a key part of cottage gardens. They are a must for arches, they soften walls, posts, fences and cover sheds and verandas to give delightful rambling cottage effect. Climbing roses and cottage gardens go hand in hand, try; Climbing Cecile Brunner, Iceberg, Lorraine Lee, Pierre de Ronsard, the classic Souvenir de la Malmaison and the almost thornless, Zepherine Drouhin. Also consider fragrant climbers like Chinese Star Jasmine and of course what cottage garden would be complete without Wisteria.*

Bower of Beauty (Pandorea jasminoides), Boston Ivy, romantic climbing roses, Honeysuckle, Native Wisteria, Potato Creepers, Chinese Star Jasmine, Virginia Creeper and Wisterias including the classic lavender blue Chinese Wisteria.

### **Trees**

*Our cottage garden trees constantly change with the seasons providing year round interest in the garden.*

Chinese Tallow Tree, Flinders Range Wattle, Flowering Peach, Manchurian Pears, Ornamental Plums like Prunus Blireiana and Nigra,

### **Shrubs**

*To add delicious fragrance to your garden try creamy Gardenias, Orange Jessamine, Night Scented Jasmine and Port Wine Magnolia. Useful hedging plants include: African Boxwood, Diosma, Laurustinus, Plumbago and Syzygium Tiny Trev and Bush Christmas. Don't forget roses, a must for all cottage gardens.*

African Boxwood, Cape Wedding Bush, Chinese Lantern, Diosma, Duranta China Girl, Dwarf Metrosideros Tahiti, Euonymus Tom Thumb, Geraldton Wax, Gardenias including Aimee Yoshiba and Golden Magic, Grevilleas, Hebe's including Wiri Charm, Hibiscus including Apple Blossom, Indigo Bush, Lantanas, Lasiandra Jules, Lavenders, Laurustinus, Orange Jessamine, Night scented Jasmine, Plumbagos including Royal Cape, Port Wine Magnolia, Syzygium Bush Christmas and Tiny Trev, Rosemary, Roses including David Austin Varieties to add an Old World Charm, Tea Trees, Topiary Standard Bush Christmas, Lilly Pilly and Solanum Royal robe.

### **Perennials**

*A good mixture of hardy, long flowering perennials form the backbone of the cottage garden. Choose a variety of heights, colours and textures and interplant with roses and shrubs for a true cottage flower garden.*

Agapathus, Bidens (Golden Daisy), Coreopsis, Convolvulus Full Moon, Cineraria Silver Dust, Cuphea, Dampiera, Day Lilies, Exhibition Border (Alternanthera), Felicia (Blue Marguerite Daisy), Geraniums, Liriopes including Evergreen Giant, Native Rock Daisy (Brachycome), Native Violet, Paris Daisy, Perennial Statice, Salvia, Scaevola Purple Fanfare, Sisyrinchium Devon Skies and Wild Iris.



#### **FORRESTFIELD**

160 Hale Road  
Ph 94536533  
Fax 94539520

#### **SWANBOURNE**

153 Railway Street  
Ph 93849652  
Fax 93832108

#### **O'CONNOR**

388 South Street  
Ph 93147258  
Fax 93147264

#### **JOONDALUP**

Cnr Joondalup Drv  
& Cord St  
Ph 93000733  
Fax 93001244

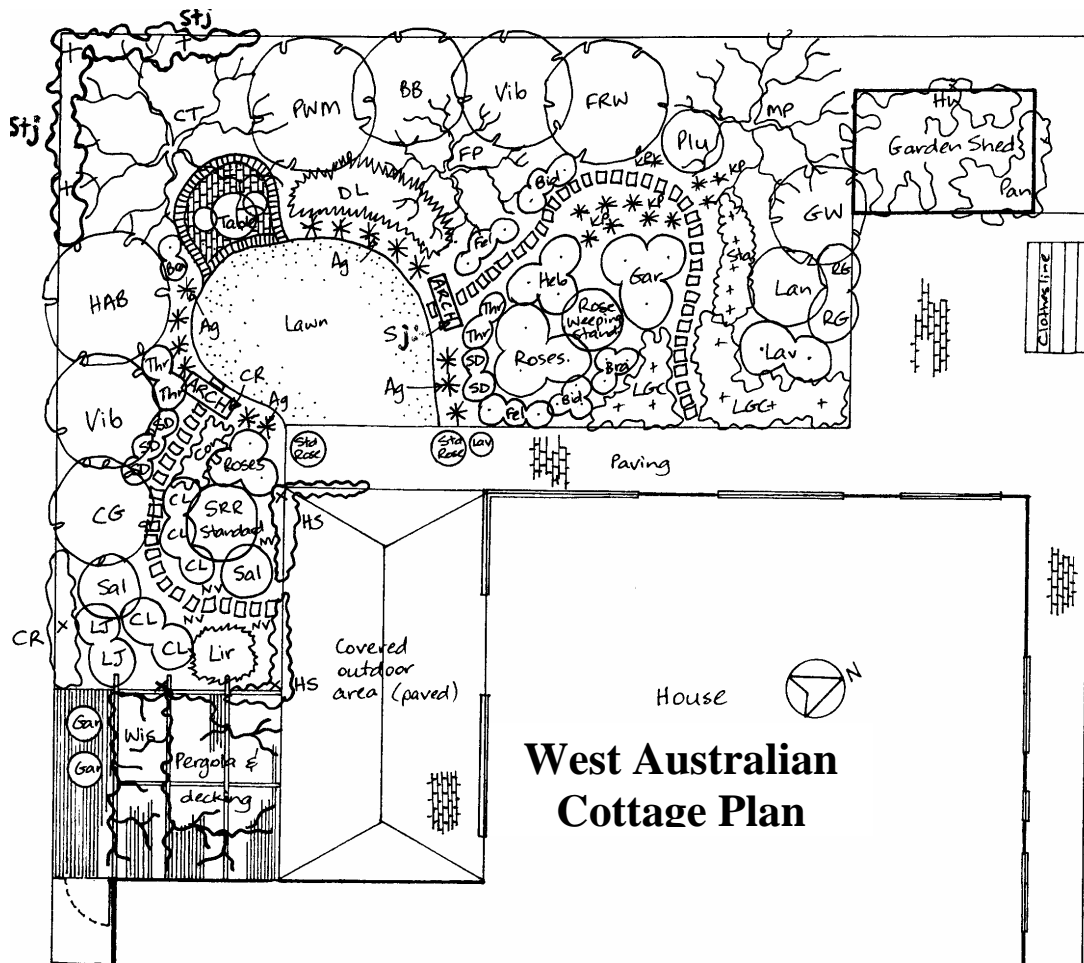

## West Australian Cottage Plan

### Key To West Australian Cottage Plan

#### Dawson's Landscaping Tips.

1. Always use Soil Improver when planting.
2. Mass plant for greater effect.
3. Dawson's roses are grown on fortuniana rootstock. The best for local conditions.
4. Long flowering perennials make cottage gardening easy.

\*\*\* Customers, this plan is provided as an example. The plants used and listed in this leaflet are subject to seasonal availability\*\*\*

Plan by Gia Clarke, Dawson's Joondalup.

© Dawson's Garden World 2003.

*Our qualified staff, are happy to assist you in selecting plants for your garden.*

**Happy gardening!**

**Great Gardens Start At Dawson's**

**Ag** = Agapanthus

**BB** = Blue Butterfly Bush (available Nov-December).

**Bid** = Bidens Daisy

**Bra** = Brachyeme (Native Rock Daisy).

**CG** = Duranta China Girl

**CL** = Chinese Lantern

**CR** = Climbing Rose

**CT** = Chinese Tallow

**DL** = Day Lily

**Fel** = Felicia

**FP** = Flowering Plum

**FRW** = Flinder's Range Wattle

**Gar** = Gardenias

**Gw** = Geraldton Wax

**HAB** = Hibiscus Apple Blossom

**Heb** = Hebe

**HS** = Honeysuckle

**Hw** = Hardenbergia Happy Wanderer (Native Wisteria).

**KP** = Kangaroo Paws

**Lan** = Lantana shrub type

**Lav** = Lavender

**LGC** = Lantana ground cover

**Lir** = Liriope

**LJ** = Lasiandra Jules

**MP** = Manchurian Pear Tree

**Nv** = Native Violet

**Pan** = Pandorea

**Plu** = Plumbago

**PWM** = Port Wine Magnolia

**RG** = Grevillea Robyn Gordon

**Roses** = Roses

**Sal** = Salvia

**SD** = Cineraria Silver Dust

**Sj** = Solanum jasminoides (Potato Jasmine).

**Sta** = Perennial Statice

**Stj** = Chinese Star Jasmine

**SRR** = Standard Solanum Royal Robe.

**Thr** = Thryptomene

**Vib** = Viburnum

**Wis** = Wisteria



**FORRESTFIELD**  
160 Hale Road  
Ph 94536533  
Fax 94539520

**SWANBOURNE**  
153 Railway Street  
Ph 93849652  
Fax 93832108

**O'CONNOR**  
388 South Street  
Ph 93147258  
Fax 93147264

**JOONDALUP**  
Cnr Joondalup Drv  
& Cord St  
Ph 93000733  
Fax 93001244

[www.dawsonsgardenworld.com.au](http://www.dawsonsgardenworld.com.au)